

**BELL+HOWELL**

**BH2K1032**



**BH2K1032 User's Manual**

## 1. About Your Binoculars

1

### **About this Manual**

Congratulations on purchasing the Bell+Howell BH2K1032 Digital Camera Binoculars! The contents of this manual are subject to change without notice. Note that the example screens and product illustrations shown in this User's Guide may differ somewhat from the screens and configuration of the actual camera.

### **Copyright**

This manual contains proprietary information protected by copyright. All rights are reserved. No part of this manual may be reproduced by any mechanical, electronic or other means, in any form, without prior written permission of Elite Brands Inc. © 2023.

### **FEDERAL COMMUNICATIONS COMMISSION INTERFERENCE STATEMENT**

This equipment has been tested and found to comply with the limits for a Class B digital device, pursuant to Part 15 of the FCC Rules. These limits are designed to provide reasonable protection against harmful interference in a residential installation. This equipment generates, uses and can radiate radio frequency energy and, if not installed and used in accordance with the instructions, may cause harmful interference to radio communications. However, there is no guarantee that interference will not occur in a particular installation. If this equipment does cause harmful interference to radio or television reception, which can be determined by turning the equipment off and on, the user is encouraged to try to correct the interference by one or more of the following measures:

- Reorient or relocate the receiving antenna.
- Increase the separation between the equipment and receiver.
- Connect the equipment into an outlet on a circuit different from that to which the receiver is connected.
- Consult the dealer or an experienced radio/TV technician for help.

### **CAUTION:**

Any changes or modifications not expressly approved by the party responsible for compliance could void the user's authority to operate the equipment. This device complies with Part 15 of the FCC Rules. Operation is subject to the following two conditions:

- (1) This device may not cause harmful interference and
- (2) This device must accept any interference received, including interference that may cause undesired operation.

### **RF Exposure Warning**

This equipment complies with FCC RF radiation exposure limits set forth for an uncontrolled environment. This equipment must be installed and operated in

---

## 1. About Your Binoculars

accordance with provided instructions and must not be co-located or operating in conjunction with any other antenna or transmitter. End-users and installers must be provided with antenna installation instructions and transmitter operating conditions for satisfying RF exposure compliance.  
FCC: SAR standard Value: 1.6 W/Kg, Maximal Measure: 0.4 W/kg

### CE Mark Warning

This is a Class B product, in a domestic environment, this product may cause radio interference, in which case the user may be required to take adequate measures.

### Safety and Handling Precautions

#### Camera Information

- Do not disassemble or attempt to service the camera yourself.
- Do not expose the camera to moisture, or extreme temperatures.
- Allow the camera to warm up when moving from cold to warm temperatures.
- Do not touch and put pressure on the camera lens.
- Do not expose the lens to direct sunlight for extended periods.
- Do not use abrasive chemicals, cleaning solvents or strong detergents to clean the product. Wipe the product with a slightly damp soft cloth.
- Do not use the flash or LED Light near a person's eyes to prevent possible eye injury.
- To prevent you from falling over or resulting in traffic accident, please do not use the camera while you are walking, driving or riding a vehicle.
- Please handle the camera strap with care, and never place the strap around the neck of an infant or child. Wrapping the strap around a neck may cause suffocation.
- Do not subject the LCD screen to impact.
- To prevent the risk of fire or electric shock, do not expose this appliance to rain or moisture.

#### Battery Information

- Turn off the camera before installing or removing the battery.
- Use only the provided batteries or type of battery and charger that came with your camera. Using other types of battery or charger may damage the device and invalidate the warranty.
- Inserting the battery upside down can cause damage to the product

---

## 1. About Your Binoculars

3

and possibly cause an explosion.

- When the camera is used for an extended period of time, it is normal for the camera body to feel warm.
- Download all pictures and remove the battery from the camera if you are going to store the camera for a long period of time.
- The type of battery and the battery power level may cause the lens to be stuck up. Ensure you use the correct battery type and use a fully charged battery.
- Risk of explosion if battery is replaced by an incorrect type. Dispose of used batteries according to the instructions.
- Please keep the batteries out of the reach of children to prevent from swallowing batteries, which might cause poisoning.
- Once the battery's color changes or its shape is twisted, please stop using it.

### USB Adaptor Information

- Do not expose the adaptor to high temperatures or moisture places. Otherwise, it may cause fire or electric shock.
- Do not attempt to repair, disassemble, change or transform the adaptor.
- Avoid sudden changes in temperature, which may cause condensation on the adaptor's internal surfaces. Please do not use it immediately in this situation.
- Do not touch the plug with wet hands. Otherwise, it may cause electric shock.
- Do not use the travel voltage converter or AC/DC power inverter. Otherwise, it may cause damage, overheating, malfunction or fire to the camera.

## 1. About Your Binoculars

4

### 1.1 Digital Camera Binocular Interface

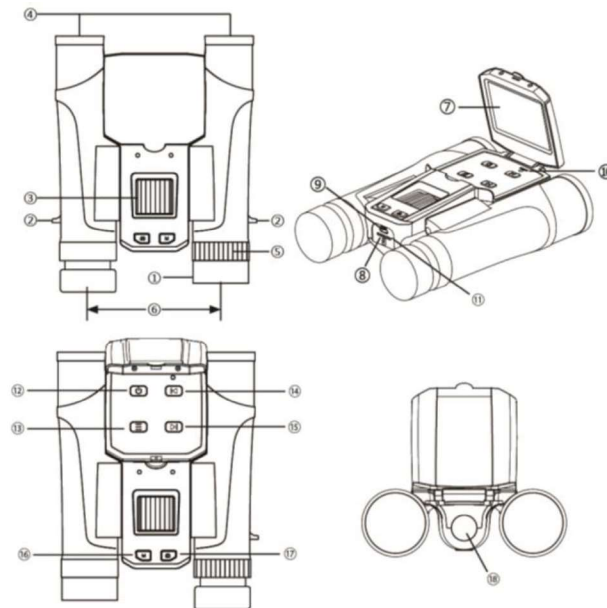

1. Eyecups	7. LCD Screen	13. Menu Button
2. Neck Strap Eyelets	8. Memory Card Slot	14. Left/Zoom In Button
3. Focusing Ring	9. USB Port	15. Right/Zoom Out Button
4. Objective Lens	10. Reset Button	16. Mode Button
5. Diopter Ring	11. Status LED	17. Shutter/Ok Button
6. Interpupillary Distance	12. Power Button	18. Camera Lens

## 1. About Your Binoculars

5

### 1.2 Button Function Description

Function	Description
<b>Power</b>	Press once to power on and press and hold for 3 seconds to power off.
<b>Mode</b>	Tap to cycle between Photo, Video and Playback modes.
<b>Menu</b>	Tap to access and exit all menus and submenus.
<b>Left   Zoom In</b>	<b>In Video or Photo:</b> Press and hold to zoom in. <b>In menu:</b> Press to navigate menus and options. <b>In Playback:</b> Press to scroll through media gallery.
<b>Right   Zoom Out</b>	<b>In Video or Photo:</b> Press and hold to zoom out. <b>In Menu:</b> Press to navigate menus and options. <b>In Playback:</b> Press to scroll through media gallery.
<b>Photo   OK</b>	<b>In Photo:</b> Tap to capture a photo. <b>In Video:</b> Tap to start and stop recording. OK button in menus. Tap to confirm a setting
<b>Tripod Mount</b>	Mount port for attaching to a tripod nut.
<b>Speaker</b>	Built-in speaker output for playback of video files.
<b>Lens</b>	Front capture device for all video and photo.
<b>Memory Card Slot</b>	Used for inserting a memory card.
<b>Micro USB Port</b>	Used to charge the camera and for connecting to a computer.

**2. First Use**

**2.1 Inserting the Memory Card**

Insert the included memory card to record and store your videos and photos. When the battery is low, media stored on the memory card will not be erased. Please insert the memory card by following the steps below:

Insert the memory card (A) into the memory card slot (B). Ensure that the metal contacts are inserted first. Push the memory card down until you hear an audible click.

The memory card can only be inserted in one way. Do not force the card in if it will not go in smoothly.

To remove the memory card, simply push in and the card will eject back out.

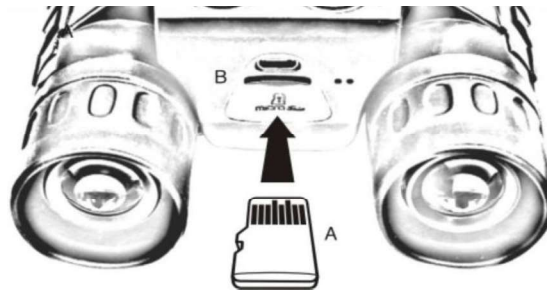

- NOTE:**
- Please format the memory card before using the camera **(Caution, this will erase all data on the card).**
  - Do not remove or insert the memory card when recording. It may damage the card or cause data loss.
  - Memory card rating must be Class 10 or above.

### 2.2 Charging the Battery

Connect your camera to the included AC adaptor with the USB cable provided for charging. Insert the small end of the USB plug into the camera's port, and the larger end in to the included AC adaptor.

### 2.3 Powering the Camera On/Off

Press the **POWER** button once to power the camera on. To power the camera off, press and hold the **POWER** button for 3 seconds.

**The camera will not automatically power on and off when the screen is opened or closed. You must manually power the camera off.**

If the camera's battery is low, a "Low Power" message will display on the screen and it will automatically shut down within a few seconds to prevent memory corruption or loss.

### 2.4 Switching Modes

Press the **MODE** button to cycle between Photo, Video and Playback Modes. The corresponding mode will be displayed in the top left corner of the screen.

### 2.5 Using the Zoom Function

This camera has a digital zoom function. To operate the zoom function, press and hold the **LEFT** button to zoom in closer to the subject, and press and hold the **RIGHT** button to zoom away from the subject.



**3. Using the Binoculars**

**3.1 Adjusting Eye Piece Distance**

1. Hold the binoculars to your eyes in the regular viewing position.
2. Grasp each barrel A and B firmly. Move the barrels closer together or further apart until you see a single circle through the eye pieces.
3. Adjustments may be necessary in between uses as the sides might change positions.



**3.2 Focusing Eye Pieces**

1. Look through the eye pieces. While closing your right eye, look only with your left eye and rotate the center knob (A) in either direction until your view comes into clear focus.
2. Closing your left eye, look with your right eye and rotate the right eye piece (B) until your view is clear.

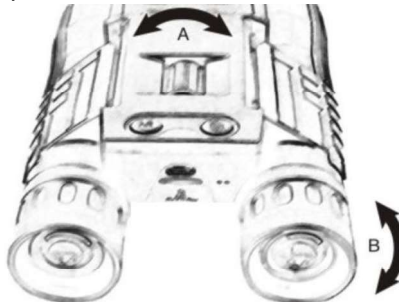

### 3. Using Your Binoculars

---

9

#### 3.3 Maintenance and Cleaning

- Only use a clean microfiber cloth to clean fingerprints and dust from the lenses.
- Only use liquid cleaning products specifically designed for prescription glasses.
- Do not disassemble or try and clean inside the binoculars.
- Store the binoculars in a dry or ventilated place when not using them.

**CAUTION: Do not look at the sun with the binoculars. You can cause permanent damage to your eyes.**

#### 3.4 Quick Tips on Using the Camera

##### 3.4.1 Mode Options

With the camera powered on, press the **MODE** button to select the mode you want to use: PHOTO Mode, PLAYBACK Mode and VIDEO Mode.

##### 3.4.2 Photo Mode

The camera automatically enters PHOTO Mode when powered on. You can either take a photo when looking through the binocular lenses or with the LCD screen open. Press the **SHUTTER** button to capture a photo.

##### 3.4.3 Video Mode

Press the **MODE** button to switch to video mode and then press the **SHUTTER** button to start recording the video. Press the **SHUTTER** button again to stop the recording.

##### 3.4.4 Playback Mode

Press the **MODE** button to switch to PLAYBACK Mode and press the **LEFT** and **RIGHT** buttons to select the photos or video files you want to view. Press the **SHUTTER/OK** button to play the videos or to show the photos.

##### 3.4.5 Digital Zoom

To use the digital zoom, press and hold the **LEFT** and **RIGHT** buttons when in Photo or Video modes to select the range of the digital zoom you want.

### **3. Using Your Binoculars**

---

10

For a better result on your photos and videos, hold the binocular tightly or attach a tripod to prevent any shakes during the recording.

**4. Using the Camera and Changing Settings****4.1 Photo Shooting**

Power the camera on and it will be ready to take pictures right away.

1. You can either look through the binocular eyepieces or line up your shot by looking at the LCD screen to see what is in the shot.
2. Press and hold the **LEFT** or **RIGHT** buttons to zoom in or out.
3. Hold the camera steady and press the **SHUTTER/OK** button to capture a photo.
4. The number of photos that can be captured at a particular resolution will be displayed in the top right corner of the screen.
5. The memory card icon on the screen will have a cross through it if there is no memory card inserted in the camera's memory card slot. A "card full" message will be shown on the screen when the memory card is full.
6. The number of remaining photos is determined by the selected photo resolution. The higher the photo resolution, the lower the number of photos you are able to be save to the memory card. Before capturing any photos, you can select a preferred photo resolution.

**4.1.1 Photo Capture Mode**

This setting allows you to select the photo capture mode, either a single photo or 3 consecutive pictures automatically.

1. In Photo Mode press the **MENU** button.
2. Select '*Photo Capture Mode*' using **LEFT** or **RIGHT** buttons and press the **SHUTTER/OK** button to enter the '*Photo Capture Mode*' submenu.
3. Press the **LEFT** or **RIGHT** buttons to navigate the menu, and press the **SHUTTER/OK** button to confirm the selected option (*Single, 3-Photo Burst, Cancel*).
4. Press the **MENU** button to exit the menu without making a selection.

**4.1.2 Self Timer**

This function determines the time delay before a photograph is captured.

1. In Photo Mode press the **MENU** button.
2. Select '*Self Timer*' using **LEFT** or **RIGHT** buttons and press the **SHUTTER/OK** button to enter the '*Self Timer*' submenu.
3. Press the **LEFT** or **RIGHT** buttons to navigate the menu, and press the

- SHUTTER/OK** button to confirm the selected option (*Off, 2 Seconds, 5 Seconds, 10 Seconds, Cancel*).
4. Press the **MENU** button to exit the menu without making a selection.

### 4.1.3 Image Size (Resolution)

This function sets the photo resolution. The higher the resolution, the greater the photo quality and the larger the file size of the photo.

1. In Photo Mode press the **MENU** button.
2. Select '*Image Size*' using the **LEFT** or **RIGHT** buttons and press the **SHUTTER/OK** button to enter the '*Image Size*' submenu.
3. Press the **LEFT** or **RIGHT** buttons to navigate the menu, and press the **SHUTTER/OK** button to confirm the selected photo resolution (*48MP, 30MP, 24MP, 20MP, 16MP, 12MP, 10MP, 8MP, 7MP, 5MP, 3MP, 2MP, Cancel*).
4. Press the **MENU** button to exit the menu without making a selection.

### 4.1.3 Scene Mode

This function adjusts the camera's settings to predetermined values that will produce the best image for that selected scene.

1. In Photo Mode press the **MENU** button.
2. Select '*Scene Mode*' using the **LEFT** or **RIGHT** buttons and press the **SHUTTER/OK** button to enter the '*Scene Mode*' submenu.
3. Press the **LEFT** or **RIGHT** buttons to navigate the menu, and press the **SHUTTER/OK** button to confirm the selected photo resolution (*Auto, Night, Portrait, Landscape, Backlight, Sport, Party, Beach, High Sensitivity, Cancel*).
4. Press the **MENU** button to exit the menu without making a selection.

### 4.1.4 Anti-Shake

This function enables photo capture in high speed and low-light by electronically minimizing motion blur and reducing camcorder shake.

1. In Photo Mode press the **MENU** button.
2. Select '*Anti-Shake*' using the **LEFT** or **RIGHT** buttons and press the **SHUTTER/OK** button to enter the '*Anti-Shake*' submenu.
3. Press the **LEFT** or **RIGHT** buttons to navigate the menu, and press the **SHUTTER/OK** button to confirm the selected photo resolution (*On, Off,*

*Cancel*).

4. Press the **MENU** button to exit the menu without making a selection.

### 4.1.5 ISO

This function adjusts the light sensitivity in your photograph.

1. In Photo Mode press the **MENU** button.
2. Select '*ISO*' using the **LEFT** or **RIGHT** buttons and press the **SHUTTER/OK** button to enter the '*ISO*' submenu.
3. Press the **LEFT** or **RIGHT** buttons to navigate the menu, and press the **SHUTTER/OK** button to confirm the selected photo resolution (*Auto, 100, 200, 400, Cancel*).
4. Press the **MENU** button to exit the menu without making a selection.

### 4.1.6 Exposure

This function adjusts the frame brightness in your video.

1. In Photo Mode press the **MENU** button.
2. Select '*Exposure*' using the **LEFT** or **RIGHT** buttons and press the **SHUTTER/OK** button to enter the '*Exposure*' submenu.
3. Press the **LEFT** or **RIGHT** buttons to navigate the menu, and press the **SHUTTER/OK** button to confirm the selected photo resolution (*+3, +2, +1, 0, -1, -2, -3, Cancel*).
4. Press the **MENU** button to exit the menu without making a selection.

### 4.1.7 White Balance

White Balance changes the color of light in your pictures, making it seem warmer or cooler depending on how the light you're shooting in affects the frame.

1. In Photo Mode press the **MENU** button.
2. Select '*White Balance*' using the **LEFT** or **RIGHT** buttons and press the **SHUTTER/OK** button to enter the '*White Balance*' submenu.
3. Press the **LEFT** or **RIGHT** buttons to navigate the menu, and press the **SHUTTER/OK** button to confirm the selected photo resolution (*Auto, Daylight, Cloudy, Fluorescent, Tungsten, Cancel*).
4. Press the **MENU** button to exit the menu without making a selection.

### 4.1.8 Quality

The Photo Quality function determines the level of compression the camera uses when saving photos to a memory card.

1. In Photo Mode press the **MENU** button.
2. Select '*Quality*' using the **LEFT** or **RIGHT** buttons and press the **SHUTTER/OK** button to enter the '*Quality*' submenu.
3. Press the **LEFT** or **RIGHT** buttons to navigate the menu, and press the **SHUTTER/OK** button to confirm the selected photo resolution (*Super Fine, Fine, Normal, Cancel*). Super Fine uses the least amount of compression for saving, and as a result produces a higher photo quality.
4. Press the **MENU** button to exit the menu without making a selection.

### 4.1.9 Sharpness

This function adjusts the visible detail of a photograph.

1. In Photo Mode press the **MENU** button.
2. Select '*Sharpness*' using the **LEFT** or **RIGHT** buttons and press the **SHUTTER/OK** button to enter the '*Sharpness*' submenu.
3. Press the **LEFT** or **RIGHT** buttons to navigate the menu, and press the **SHUTTER/OK** button to confirm the selected photo resolution (*Sharp, Normal, Soft, Cancel*).
4. Press the **MENU** button to exit the menu without making a selection.

### 4.1.10 Color Effect

This function sets the color filter effect of a photograph.

1. In Photo Mode press the **MENU** button.
2. Select '*Color Effect*' using the **LEFT** or **RIGHT** buttons and press the **SHUTTER/OK** button to enter the '*Color Effect*' submenu.
3. Press the **LEFT** or **RIGHT** buttons to navigate the menu, and press the **SHUTTER/OK** button to confirm the selected photo resolution (*Normal, Black & White, Sepia, Red, Green, Blue, Sunset, Warm, Cool, Over Exposure, IR, Binary, Vivid, Undertone, Dog Eye, Aibao, Gothic, Japan Style, LOMO, Negative, Cancel*).
4. Press the **MENU** button to exit the menu without making a selection.

### 4.1.11 Date Stamp

This setting allows you to imprint a date & time onto your recorded video files.

## 4. Using Camera / Change Settings

15

Once a video file is recorded with the imprint, the imprint cannot be removed.

1. In Photo Mode press the **MENU** button.
2. Select '*Date Stamp*' using the **LEFT** or **RIGHT** buttons and press the **SHUTTER/OK** button to enter the '*Date Stamp*' submenu.
3. Press the **LEFT** or **RIGHT** buttons to navigate the menu, and press the **SHUTTER/OK** button to confirm the selected option (*Off, Date, Date & Time, Cancel*).
4. Press the **MENU** button to exit the menu without making a selection.

**Note:** *Once a date/time stamp is captured on a photograph or video, it cannot be removed.*

### 4.1.12 Language

This function allows you to set the camera's interface language.

1. In Photo or Video Modes press the **MENU** button.
2. Select '*Setup*' using the **LEFT** or **RIGHT** buttons and press the **SHUTTER/OK** button to enter the '*Setup*' submenu.
3. Select '*Language*' using the **LEFT** or **RIGHT** buttons and press the **SHUTTER/OK** button to enter the '*Language*' submenu.
4. Press the **LEFT** or **RIGHT** buttons to navigate the menu, and press the **SHUTTER/OK** button to confirm the selected option.
5. Press the **MENU** button to exit the menu without making a selection.

### 4.1.13 Set Date

This function allows you to set the current Date and Time on your recorded video clips and captured photos.

1. In Photo or Video Modes press the **MENU** button.
2. Select '*Setup*' using the **LEFT** or **RIGHT** buttons and press the **SHUTTER/OK** button to enter the '*Setup*' submenu.
3. Select '*Set Date*' using the **LEFT** or **RIGHT** buttons and press the **SHUTTER/OK** button to enter the '*Set Date*' submenu.
4. Press the **SHUTTER/OK** button to switch between year, month, day, hours, minutes and seconds.
5. Once your desired field is highlighted, press the **LEFT** or **RIGHT** buttons to cycle through numbers.
6. Once completed with all of the fields, press the **MODE** button to confirm the changes and exit the menu.



### 4.1.14 Auto Power Off

This function sets the duration of time in which the camera will wait with no user input before automatically powering off.

1. In Photo or Video Modes press the **MENU** button.
2. Select 'Setup' using the **LEFT** or **RIGHT** buttons and press the **SHUTTER/OK** button to enter the 'Setup' submenu.
3. Select 'Auto Power Off' using the **LEFT** or **RIGHT** buttons and press the **SHUTTER/OK** button to enter the 'Auto Power Off' submenu.
4. Press the **LEFT** or **RIGHT** buttons to navigate the menu, and press the **SHUTTER/OK** button to confirm the selected option (*Off, 1 Minute, 3 Minutes, 5 Minutes, Cancel*).
5. Press the **MENU** button to exit the menu without making a selection.

### 4.1.15 Button Sound

This function allows you to turn off the sound the camera makes when you press a button.

1. In Photo or Video Modes press the **MENU** button.
2. Select 'Setup' using the **LEFT** or **RIGHT** buttons and press the **SHUTTER/OK** button to enter the 'Setup' submenu.
3. Select 'Button Sound' using the **LEFT** or **RIGHT** buttons and press the **SHUTTER/OK** button to enter the 'Button Sound' submenu.
4. Press the **LEFT** or **RIGHT** buttons to navigate the menu, and press the **SHUTTER/OK** button to confirm the selected photo resolution (*On, Off, Cancel*).
5. Press the **MENU** button to exit the menu without making a selection.

### 4.1.16 Frequency

This function sets the frequency of the camera from 50Hz to 60Hz. Please check the frequency of your location and set accordingly.

1. In Photo or Video Modes press the **MENU** button.
2. Select 'Setup' using the **LEFT** or **RIGHT** buttons and press the **SHUTTER/OK** button to enter the 'Setup' submenu.
3. Select 'Frequency' using the **LEFT** or **RIGHT** buttons and press the **SHUTTER/OK** button to enter the 'Frequency' submenu.
4. Press the **LEFT** or **RIGHT** buttons to navigate the menu, and press the **SHUTTER/OK** button to confirm the selected photo resolution (*60 Hz, 50*).

- Hz, Cancel*). The default frequency for the United States is 60Hz.
5. Press the **MENU** button to exit the menu without making a selection.

### 4.1.17 Format Memory Card

The format setting erases all photos, videos and data stored on your memory card.

1. In Photo or Video Modes press the **MENU** button.
2. Select '*Setup*' using the **LEFT** or **RIGHT** buttons and press the **SHUTTER/OK** button to enter the '*Setup*' submenu.
3. Select '*Format Memory Card*' using the **LEFT** or **RIGHT** buttons and press the **SHUTTER/OK** button to enter the '*Format Memory Card*' submenu.
4. Press the **LEFT** or **RIGHT** buttons to navigate the menu, and press the **SHUTTER/OK** button to confirm the selected option (*Yes, No*).
5. Press the **MENU** button to exit the menu without making a selection.

**NOTE: This will delete all of your media and cannot be undone**

### 4.1.18 Restore Default Setting

Factory default settings can be restored in this menu. This function will not delete the media stored on the memory card, and will only restore all of the menu's setting back to factory default settings.

1. In Photo or Video Modes press the **MENU** button.
2. Select '*Setup*' using the **LEFT** or **RIGHT** buttons and press the **SHUTTER/OK** button to enter the '*Setup*' submenu.
3. Select '*Restore Default*' using the **LEFT** or **RIGHT** buttons and press the **SHUTTER/OK** button to enter the '*Restore Default*' submenu.
4. Press the **LEFT** or **RIGHT** buttons to navigate the menu, and press the **SHUTTER/OK** button to confirm the selected option (*Yes, No*).
5. Press the **MENU** button to exit the menu without making a selection.

### 4.2 Video Recording

Power the camera on and press the **MODE** button to switch modes. A video camera icon will appear in the top left corner of the screen when you are in Video mode.

1. You can either look through the binocular eyepieces or line up your shot by looking at the LCD screen to see what is in the shot.
2. Press and hold the **LEFT** or **RIGHT** buttons to zoom in or out.
3. The amount of time that can be recorded in the current settings is displayed in the top right corner of the screen.
4. Hold the binoculars steady and press the **SHUTTER/OK** button to begin recording.
5. When recording begins, a rolling timer will display in red in the top right corner of the screen. This indicates the recorded video time elapsed.
6. Press the **SHUTTER/OK** button to stop recording.
7. The recorded video files will automatically save onto the inserted memory card.

#### 4.2.1 Movie Size (Resolution)

Your camera has a number of preset resolutions.

1. In Video Mode press the **MENU** button.
2. Select '*Movie Size*' using the **LEFT** or **RIGHT** buttons and press the **SHUTTER/OK** button to enter the '*Movie Size*' submenu.
3. Press the **LEFT** or **RIGHT** buttons to navigate the menu, and press the **SHUTTER/OK** button to confirm the selected photo resolution (*2.7K, 1080P, 720P, 480P, Cancel*). A higher resolution will produce a higher quality and larger video file.
4. Press the **MENU** button to exit the menu without making a selection.

#### 4.2.2 Scene Mode

This function adjusts the camera's settings to predetermined values that will produce the best image for that selected scene.

1. In Video Mode press the **MENU** button.
2. Select '*Scene Mode*' using the **LEFT** or **RIGHT** buttons and press the **SHUTTER/OK** button to enter the '*Scene Mode*' submenu.
3. Press the **LEFT** or **RIGHT** buttons to navigate the menu, and press the

**SHUTTER/OK** button to confirm the selected photo resolution (*Auto, Night, Portrait, Landscape, Backlight, Sport, Party, Beach, High Sensitivity, Cancel*).

4. Press the **MENU** button to exit the menu without making a selection.

### 4.2.3 ISO

This function adjusts the light sensitivity in your photograph.

1. In Video Mode press the **MENU** button.
2. Select *'ISO'* using the **LEFT** or **RIGHT** buttons and press the **SHUTTER/OK** button to enter the *'ISO'* submenu.
3. Press the **LEFT** or **RIGHT** buttons to navigate the menu, and press the **SHUTTER/OK** button to confirm the selected photo resolution (*Auto, 100, 200, 400, Cancel*).
4. Press the **MENU** button to exit the menu without making a selection.

### 4.2.4 Exposure

This function adjusts the frame brightness in your video.

1. In Video Mode press the **MENU** button.
2. Select *'Exposure'* using the **LEFT** or **RIGHT** buttons and press the **SHUTTER/OK** button to enter the *'Exposure'* submenu.
3. Press the **LEFT** or **RIGHT** buttons to navigate the menu, and press the **SHUTTER/OK** button to confirm the selected photo resolution (*+3, +2, +1, 0, -1, -2, -3, Cancel*).
4. Press the **MENU** button to exit the menu without making a selection.

### 4.2.5 White Balance

White Balance changes the color of light in your pictures, making it seem warmer or cooler depending on how the light you're shooting in affects the frame.

1. In Video Mode press the **MENU** button.
2. Select *'White Balance'* using the **LEFT** or **RIGHT** buttons and press the **SHUTTER/OK** button to enter the *'White Balance'* submenu.
3. Press the **LEFT** or **RIGHT** buttons to navigate the menu, and press the **SHUTTER/OK** button to confirm the selected photo resolution (*Auto, Daylight, Cloudy, Fluorescent, Tungsten, Cancel*).
4. Press the **MENU** button to exit the menu without making a selection.

### 4.2.6 Sharpness

This function adjusts the visible detail of a photograph.

1. In Video Mode press the **MENU** button.
2. Select '*Sharpness*' using the **LEFT** or **RIGHT** buttons and press the **SHUTTER/OK** button to enter the '*Sharpness*' submenu.
3. Press the **LEFT** or **RIGHT** buttons to navigate the menu, and press the **SHUTTER/OK** button to confirm the selected photo resolution (*Sharp, Normal, Soft, Cancel*).
4. Press the **MENU** button to exit the menu without making a selection.

### 4.2.7 Color Effect

This function sets the color filter effect of a photograph.

1. In Video Mode press the **MENU** button.
2. Select '*Color Effect*' using the **LEFT** or **RIGHT** buttons and press the **SHUTTER/OK** button to enter the '*Color Effect*' submenu.
3. Press the **LEFT** or **RIGHT** buttons to navigate the menu, and press the **SHUTTER/OK** button to confirm the selected photo resolution (*Normal, Black & White, Sepia, Red, Green, Blue, Sunset, Warm, Cool, Over Exposure, IR, Binary, Vivid, Undertone, Dog Eye, Aibao, Gothic, Japan Style, LOMO, Negative, Cancel*).
4. Press the **MENU** button to exit the menu without making a selection.

### 4.2.8 Date Stamp

This setting allows you to imprint a date & time onto your recorded video files. Once a video file is recorded with the imprint, the imprint cannot be removed.

1. In Video Mode press the **MENU** button.
2. Select '*Date Stamp*' using the **LEFT** or **RIGHT** buttons and press the **SHUTTER/OK** button to enter the '*Date Stamp*' submenu.
3. Press the **LEFT** or **RIGHT** buttons to navigate the menu, and press the **SHUTTER/OK** button to confirm the selected option (*Off, Date, Date & Time, Cancel*).
4. Press the **MENU** button to exit the menu without making a selection.

**Note:** *Once a date/time stamp is captured on a photograph or video, it cannot be removed.*

**4.2.9 Language**

This function allows you to set the camera's interface language.

1. In Photo or Video Modes press the **MENU** button.
2. Select '*Setup*' using the **LEFT** or **RIGHT** buttons and press the **SHUTTER/OK** button to enter the '*Setup*' submenu.
3. Select '*Language*' using the **LEFT** or **RIGHT** buttons and press the **SHUTTER/OK** button to enter the '*Language*' submenu.
4. Press the **LEFT** or **RIGHT** buttons to navigate the menu, and press the **SHUTTER/OK** button to confirm the selected option.
5. Press the **MENU** button to exit the menu without making a selection.

**4.2.10 Set Date**

This function allows you to set the current Date and Time on your recorded video clips and captured photos.

1. In Photo or Video Modes press the **MENU** button.
2. Select '*Setup*' using the **LEFT** or **RIGHT** buttons and press the **SHUTTER/OK** button to enter the '*Setup*' submenu.
3. Select '*Set Date*' using the **LEFT** or **RIGHT** buttons and press the **SHUTTER/OK** button to enter the '*Set Date*' submenu.
4. Press the **SHUTTER/OK** button to switch between year, month, day, hours, minutes and seconds.
5. Once your desired field is highlighted, press the **LEFT** or **RIGHT** buttons to cycle through numbers.
6. Once completed with all of the fields, press the **MODE** button to confirm the changes and exit the menu.

**4.2.11 Auto Power Off**

This function sets the duration of time in which the camera will wait with no user input before automatically powering off.

1. In Photo or Video Modes press the **MENU** button.
2. Select '*Setup*' using the **LEFT** or **RIGHT** buttons and press the **SHUTTER/OK** button to enter the '*Setup*' submenu.
3. Select '*Auto Power Off*' using the **LEFT** or **RIGHT** buttons and press the **SHUTTER/OK** button to enter the '*Auto Power Off*' submenu.
4. Press the **LEFT** or **RIGHT** buttons to navigate the menu, and press the **SHUTTER/OK** button to confirm the selected option (*Off, 1 Minute, 3*

*Minutes, 5 Minutes, Cancel).*

5. Press the **MENU** button to exit the menu without making a selection.

### 4.2.12 Button Sound

This function allows you to turn off the sound the camera makes when you press a button.

1. In Photo or Video Modes press the **MENU** button.
2. Select '*Setup*' using the **LEFT** or **RIGHT** buttons and press the **SHUTTER/OK** button to enter the '*Setup*' submenu.
3. Select '*Button Sound*' using the **LEFT** or **RIGHT** buttons and press the **SHUTTER/OK** button to enter the '*Button Sound*' submenu.
4. Press the **LEFT** or **RIGHT** buttons to navigate the menu, and press the **SHUTTER/OK** button to confirm the selected photo resolution (*On, Off, Cancel*).
5. Press the **MENU** button to exit the menu without making a selection.

### 4.2.13 Frequency

This function sets the frequency of the camera from 50Hz to 60Hz. Please check the frequency of your location and set accordingly.

1. In Photo or Video Modes press the **MENU** button.
2. Select '*Setup*' using the **LEFT** or **RIGHT** buttons and press the **SHUTTER/OK** button to enter the '*Setup*' submenu.
3. Select '*Frequency*' using the **LEFT** or **RIGHT** buttons and press the **SHUTTER/OK** button to enter the '*Frequency*' submenu.
4. Press the **LEFT** or **RIGHT** buttons to navigate the menu, and press the **SHUTTER/OK** button to confirm the selected photo resolution (*60 Hz, 50 Hz, Cancel*). The default frequency for the United States is 60Hz.
5. Press the **MENU** button to exit the menu without making a selection.

### 4.2.14 Format Memory Card

The format setting erases all photos, videos and data stored on your memory card.

1. In Photo or Video Modes press the **MENU** button.
2. Select '*Setup*' using the **LEFT** or **RIGHT** buttons and press the **SHUTTER/OK** button to enter the '*Setup*' submenu.
3. Select '*Format Memory Card*' using the **LEFT** or **RIGHT** buttons and press

#### 4. Using Camera / Change Settings

23

- the **SHUTTER/OK** button to enter the *'Format Memory Card'* submenu.
4. Press the **LEFT** or **RIGHT** buttons to navigate the menu, and press the **SHUTTER/OK** button to confirm the selected option (*Yes, No*).
  5. Press the **MENU** button to exit the menu without making a selection.

**NOTE:** *This will delete all of your media and cannot be undone*

##### 4.2.15 Restore Default Setting

Factory default settings can be restored in this menu. This function will not delete the media stored on the memory card, and will only restore all of the menu's setting back to factory default settings.

1. In Photo or Video Modes press the **MENU** button.
2. Select *'Setup'* using the **LEFT** or **RIGHT** buttons and press the **SHUTTER/OK** button to enter the *'Setup'* submenu.
3. Select *'Restore Default'* using the **LEFT** or **RIGHT** buttons and press the **SHUTTER/OK** button to enter the *'Restore Default'* submenu.
4. Press the **LEFT** or **RIGHT** buttons to navigate the menu, and press the **SHUTTER/OK** button to confirm the selected option (*Yes, No*).
5. Press the **MENU** button to exit the menu without making a selection.



### 4.3 Playback Mode

Videos and photos captured on your camera can be easily played back. Power the camera on and press the MODE button to switch to Playback Mode.

1. Press the **MODE** button to enter Playback Mode. Your last recorded image or video will appear on the screen when first entering playback mode.
2. Press the **LEFT** or **RIGHT** buttons to cycle through the captured videos and photos stored on the memory card.
3. To enter into a video, press the **SHUTTER/OK** button.

In Playback Mode the following options are available:

#### 4.3.1 Delete

This function is used to delete photos and videos. Photos and videos can be deleted singly or all at once.

1. In Playback Mode press the **MENU** button.
2. Select '*Delete*' using the **LEFT** or **RIGHT** buttons and press the **SHUTTER/OK** button to enter the '*Delete*' submenu.
3. Press the **LEFT** or **RIGHT** buttons to navigate the menu, and press the **SHUTTER/OK** button for your selected setting (*This Image, All, Cancel*).
4. Press the **MENU** button to exit the menu without deleting any pictures or videos.

#### 4.3.2 Protect

This function protects the photo/video file. The file will be protected from being deleted accidentally. Files must be unprotected to be deleted.

1. In Playback Mode press the **MENU** button.
2. Select '*Protect*' using the **LEFT** or **RIGHT** buttons and press the **SHUTTER/OK** button to enter the '*Protect*' submenu.
3. Press the **LEFT** or **RIGHT** buttons to navigate the menu, and press the **SHUTTER/OK** button for your selected setting (*Lock Current, Unlock Current, Lock All, Unlock All, Cancel*).
4. Press the **MENU** button to exit the menu without making a selection.

### 4.3.3 Rotate

This function allows you to rotate stored images.

1. In Playback Mode press the **MENU** button.
2. Select '*Rotate*' using the **LEFT** or **RIGHT** buttons and press the **SHUTTER/OK** button to enter the '*Rotate*' submenu.
3. Press the **LEFT** or **RIGHT** buttons to navigate the menu, and press the **SHUTTER/OK** button for your selected setting (*90°, 180°, 270°, Cancel*).
4. Press the **MENU** button to exit the menu without making a selection.

### 4.3.4 Slide Show

Photographs can be viewed as a slide show on the camera.

1. In Playback Mode press the **MENU** button.
2. Select '*Slide Show*' using the **LEFT** or **RIGHT** buttons and press the **SHUTTER/OK** button to enter the '*Slide Show*' submenu.
3. Press the **LEFT** or **RIGHT** buttons to navigate the menu, and press the **SHUTTER/OK** button for your selected setting (*3 Seconds, 5 Seconds, 10 Seconds, Cancel*).
4. Press the **SHUTTER/OK** button to stop a playing slide show.
5. Press the **MENU** button to exit the menu without making a selection.

### 4.3.5 Video Playback

Videos can be played back and viewed on your camera.

1. In Playback Mode, press the **LEFT** or **RIGHT** buttons to select the video file for playback.
2. Press the **SHUTTER/OK** button to start playing the video. Press the **MODE** button to pause the video, press the **LEFT** button to rewind the video, press the **RIGHT** button to fast forward the video and press the **SHUTTER/OK** button to stop the video.

---

**5.1 How to Connect to Your Computer**

Connect the small end of the USB cable to the USB port on the camera. Then connect the large end of the USB cable to a USB port on your computer. If the camera is off, power it on and the LCD screen will show a USB icon on the screen. You will now be able to download the photos and videos to your computer.

## 5.2 Technical Specifications

<b>Model Number</b>	BH2K1032
<b>Magnification</b>	10x
<b>Objective Lens Diameter</b>	32mm • BK7 Fogproof Multi-Coated
<b>Optical Design</b>	Roof Prism
<b>Field of View</b>	5.5° / 314 ft. @ 1000 yds FOV
<b>Exit Pupil Diameter</b>	3.1mm
<b>Eye Relief</b>	12.6mm
<b>Interpupillary Adjustment</b>	62.0mm ~ 88.0mm
<b>Minimum Focus Distance</b>	8.0m
<b>Camera Lens</b>	Fixed Focus • f=21.0mm • F/6.0 • Electronic Stabilization
<b>Image Sensor</b>	8.0 Mega Pixels CMOS
<b>Zoom</b>	8x Digital Zoom
<b>LCD Monitor</b>	2.4 Inch LCD Anti-Glare Monitor
<b>Pixels (photo)</b>	JPEG: 48MP • 30MP • 24MP • 20MP • 16MP • 12MP • 10MP • 8MP • 7MP • 5MP • 3MP • 2MP
<b>Pixels (video)</b>	AVI: 2.7K • 1080P • 720P • 480P
<b>ISO Sensitivity</b>	Auto • 100 • 200 • 400
<b>Power Saving Mode</b>	OFF • 1 Minutes • 3 Minutes • 5 Minutes
<b>Recording Media</b>	MicroSD • MicroSDHC; Maximum: 256GB
<b>I/O Ports</b>	Micro USB • Speaker
<b>Power</b>	3.7V Lithium-Ion, 1,000 mAh non-removable
<b>Dimensions</b>	5.5 x 3.23 x 1.86 in. • 9.7 oz.

# BELL+HOWELL

*Distributed under license of BHH LLC in the United States by:  
Elite Brands Inc.*

*40 Wall Street, 61st Floor,  
New York, NY 10005 USA  
Tel: 800-441-1100*

*[www.bellhowellcameras.com](http://www.bellhowellcameras.com) • [www.elitebrands.com](http://www.elitebrands.com)  
Copyright © 2023 Elite Brands Inc.*



