



BHDC1A

VIDEO DOORBELL + CHIME USER MANUAL

About this Manual

Congratulations on purchasing the Bell+Howell BHDC1A Video Doorbell!

The contents of this manual are subject to change without notice. Note that the example screens and product illustrations shown in this User's Guide may differ somewhat from the screens and configuration of the actual doorbell and app.

Copyright

This manual contains proprietary information protected by copyright. All rights are reserved. No part of this manual may be reproduced by any mechanical, electronic or other means, in any form, without prior written permission of Elite Brands Inc. © 2021.

FEDERAL COMMUNICATIONS COMMISSION INTERFERENCE STATEMENT

This equipment has been tested and found to comply with the limits for a Class B digital device, pursuant to Part 15 of the FCC Rules. These limits are designed to provide reasonable protection against harmful interference in a residential installation. This equipment generates, uses and can radiate radio frequency energy and, if not installed and used in accordance with the instructions, may cause harmful interference to radio communications. However, there is no guarantee that interference will not occur in a particular installation. If this equipment does cause harmful interference to radio or television reception, which can be determined by turning the equipment off and on, the user is encouraged to try to correct the interference by one or more of the following measures:

- Reorient or relocate the receiving antenna.
- Increase the separation between the equipment and receiver.
- Connect the equipment into an outlet on a circuit different from that to which the receiver is connected.
- Consult the dealer or an experienced radio/TV technician for help.

CAUTION:

Any changes or modifications not expressly approved by the party responsible for compliance could void the user's authority to operate the equipment.

This device complies with Part 15 of the FCC Rules. Operation is subject to the following two conditions:

- (1) This device may not cause harmful interference and
- (2) This device must accept any interference received, including interference that may cause undesired operation.

RF Exposure Warning

This equipment complies with FCC RF radiation exposure limits set forth for an uncontrolled environment. This equipment must be installed and operated in accordance with provided instructions and must not be co-located or operating in conjunction with any other antenna or transmitter. End-users and installers must be provided with antenna installation instructions and transmitter operating

conditions for satisfying RF exposure compliance.

FCC: SAR standard Value: 1.6 W/Kg, Maximal Measure: 0.4 W/kg

CE Mark Warning

This is a Class B product, in a domestic environment, this product may cause radio interference, in which case the user may be required to take adequate measures.

Safety and Handling Precautions

Doorbell Information

- Do not disassemble or attempt to service the doorbell yourself.
- Do not submerge the doorbell in liquid.
- Do not touch and put pressure on the lens.
- Do not use abrasive chemicals, cleaning solvents or strong detergents to clean the product. Wipe the product with a slightly damp soft cloth.
- The doorbell is only IP54 weather resistant when installed with the included mounting bracket.

Chime Information

- Do not disassemble or attempt to service the chime yourself.
- Do not submerge or expose the chime to liquid.
- Do not use abrasive chemicals, cleaning solvents or strong detergents to clean the product. Wipe the product with a soft dry cloth or micro fiber cloth.
- The chime is intended for indoor use only. Do not place outdoors.
- Do not mount or place the chime near areas of high temperature.

Battery Information

- Use only the provided batteries that came with your doorbell. Using other types of batteries may damage the device and invalidate the warranty.
- Inserting the battery upside down can cause damage to the product and possibly cause an explosion.
- Risk of explosion if battery is replaced by an incorrect type. Dispose of used batteries according to the instructions and replace only with the same type, mAh and voltage.
- Please keep the batteries out of the reach of children to prevent from swallowing batteries, which might cause poisoning.
- If the battery's color or shape changes, stop using it immediately and remove it from the device.

1.1 Doorbell Interface

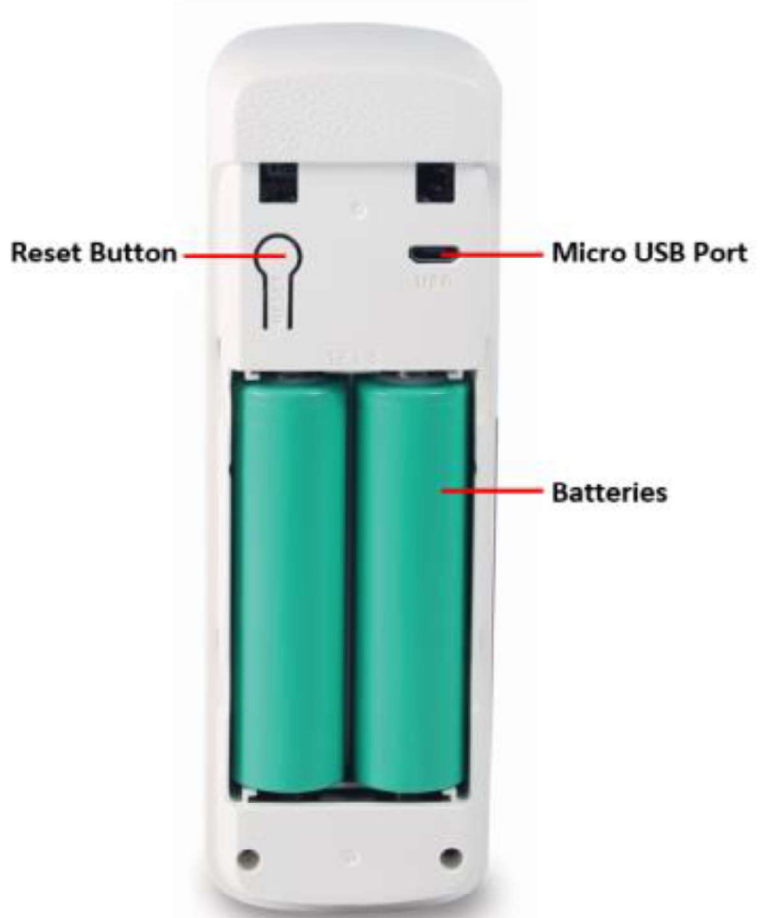
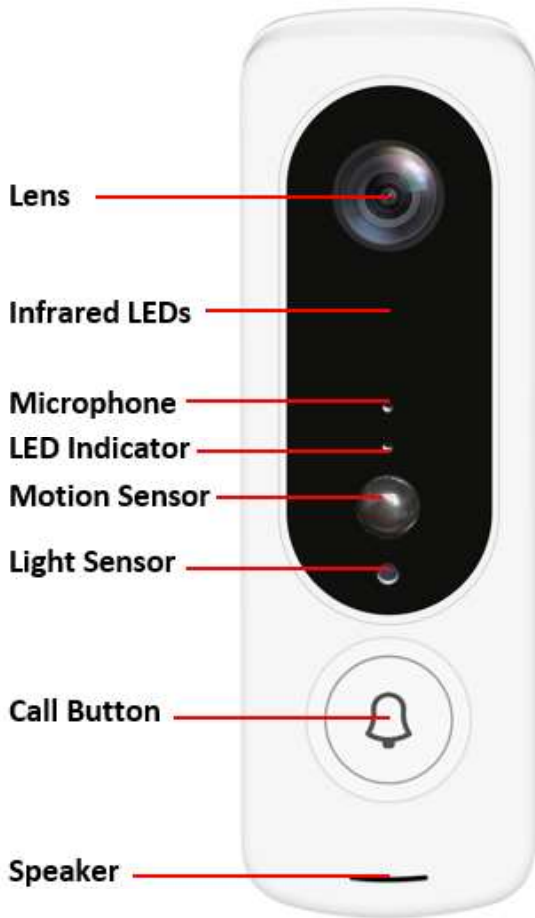

1.2 Doorbell Button Function Description

Function	Description
Lens	Front capture device for all video.
Infrared LEDs	Infrared LEDs to aid with vision and recording in darkness.
Microphone	Used to record audio for playback and two-way talk.
LED Indicator	Shows the status of the doorbell.
Motion Sensor	Detects movement in front of the doorbell.
Light Sensor	Measures the light level and activates night vision when necessary.
Call Button	Activates the doorbell.
Speaker	Built-in speaker for two-way talk.
Reset Button	Press for 5 seconds to reset the doorbell.
Micro USB Port	Plug in a USB cable to charge the doorbell.
MicroSD Cart Slot	Insert a MicroSD card for recording events for playback (without a Tuya app subscription).
Batteries	The battery compartment for powering the doorbell.
Security Screw Hole	Insert the security screw to keep the doorbell secured to the surface it's mounted on.

1.3 Chime Interface



1.4 Chime Button Function Description

Function	Description
Ring Tone Selector	Use the Up or Down buttons to go to the next or previous ring tone.
Speaker	Built-in speaker for doorbell alerts.
LED Indicator	LED lights up when the doorbell is pressed.
Volume Control	Used to adjust the volume level.

2. Doorbell First Use

2.1 Inserting a Memory Card (not included)

A memory card can be used to store recorded activity for future playback on the app. You do not need a memory card if you purchase a cloud subscription on the Tuya app. When the battery is low, media stored on the memory card will not be erased. To insert a MicroSD memory card follow the steps below:

1. Open the battery door by sliding it down towards the bottom of doorbell.
2. Remove the batteries to access the memory card slot.
3. Insert the memory card. Ensure that the metal contacts are inserted first. Push the memory card in until you hear an audible click.

Note: the memory card can only be inserted in one way. Do not force the card in if it will not go in smoothly.

4. Replace the batteries back into the doorbell. Make sure to insert them in the correct direction.
5. To remove the memory card, simply push in and the card will eject back out.

NOTE:

- Please format the memory card before using the doorbell (Caution: This will erase all data on the card).
- Do not remove or insert the memory card when recording. It may damage the card or cause data loss.
- Memory card rating must be Class 10 or above from compatible high-quality brands.

2.2 Charging the Battery

1. Open the battery door by sliding it down towards the bottom of doorbell.
2. Remove the batteries and peel off the sticker on the negative end of the batteries, exposing the metal plate. Replace the batteries in the doorbell.
3. Insert the small end of the included USB cable into the doorbell's port under the battery door and the larger end in to a USB/AC adaptor (not included).
4. Charge the batteries fully before use. The charging time for the batteries is around 7 hours using a 1A USB/AC adaptor. Under normal use, the battery charge will last 2-3 months.

Note: If the doorbell captures an excessive number of events every day the battery life will be reduced. Checking the live view or talking through the doorbell will also reduce the battery life. To reduce the number of events recorded each day, reduce the sensitivity level of the motion sensor.

2.3 IR Night Vision Mode

The doorbell has built-in infrared (IR) LEDs for night vision recording - giving you the ability to capture videos in a dark environment.

The infrared LEDs automatically activate when the level of ambient light is low.

Note:

The videos recorded while the IR LEDs are enabled will be recorded in black and white.

3. Using the Doorbell

3.1 Connecting your Doorbell to the Tuya Smart Home App

Connecting your doorbell to the Tuya Smart Home app will allow you to use the doorbell remotely. Through the app, you can get instant alerts when someone rings the doorbell, alerts when the motion sensor is triggered and see, hear and speak to visitors in real-time. To connect the doorbell to the app, follow the steps below.

1. Download the Tuya Smart Home app from either the Apple App Store or the Google Play Store. Search for “Tuya Smart” in the app store or scan the QR code below.



2. Open the Tuya Smart app, create an account and log in.
3. To add your doorbell to the app, select the + at the top right of the home screen. Then select the Security & Video Surveillance category on the left side of the screen, then select Smart Doorbell.

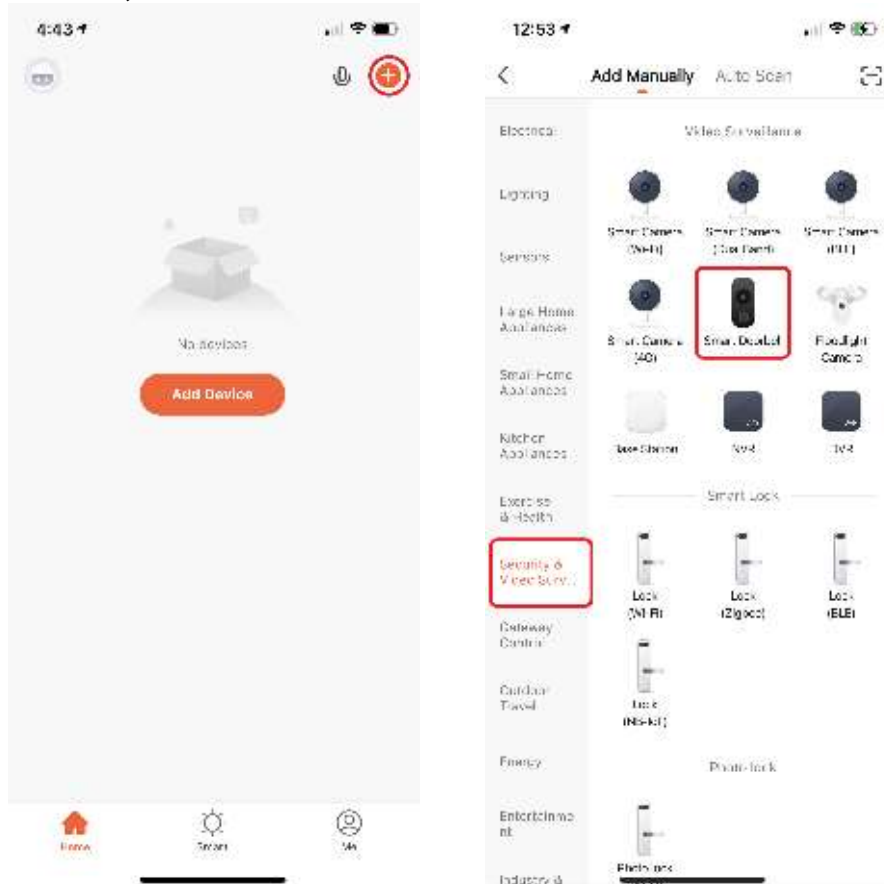

4. The app will now tell you to reset the device. Open the doorbell battery compartment, remove the batteries and remove the insulation tabs covering the ends of the batteries. Then replace the batteries. The doorbell will say “The camera is now ready to begin pairing” and a red LED will flash on the front of the doorbell.
5. In the app, select the circle indicating that you heard the prompt from the doorbell or that the front LED is flashing. Then select next.
6. Next, select the WiFi network you wish to connect your doorbell to, then enter the password for the network and select next.

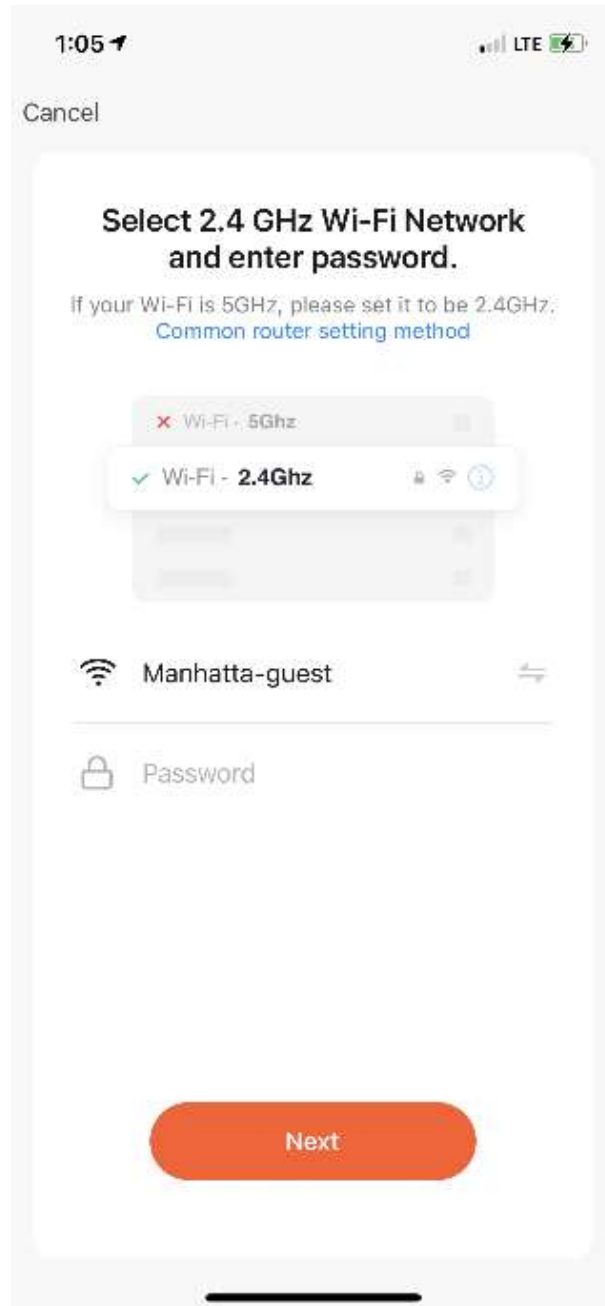

**Note: this product only works on 2.4 GHz networks.
It will not work with 5 GHz networks.**

7. A QR code will now be displayed on the app. Take the doorbell and point the doorbell lens at the QR code from approximately 4-8 inches away so that the doorbell camera lens can “see” the QR code. When you hear the confirmation tone, select “I Heard a Prompt” on the bottom of the screen to proceed.



8. The app will establish a connection with the doorbell.

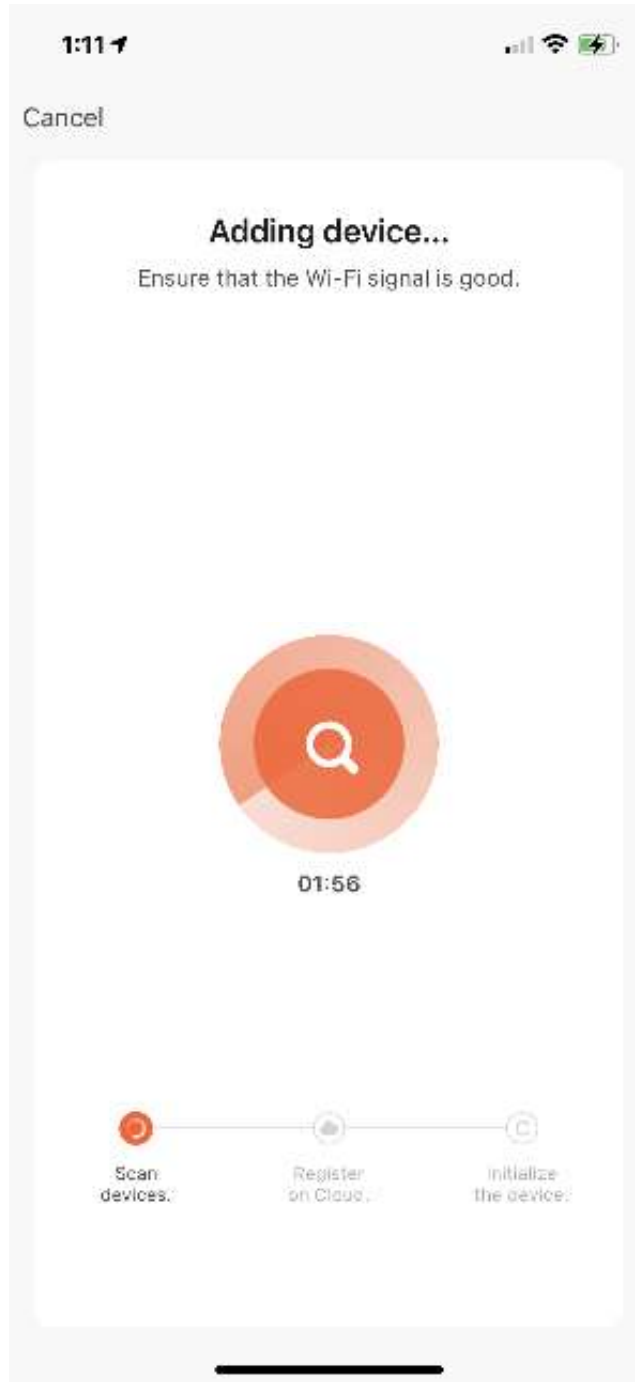

9. Once the doorbell is connected, it will show up in your devices list on the home page of the app. When you select the doorbell from the home page of the app, you will see the live view of what the doorbell is pointing at.

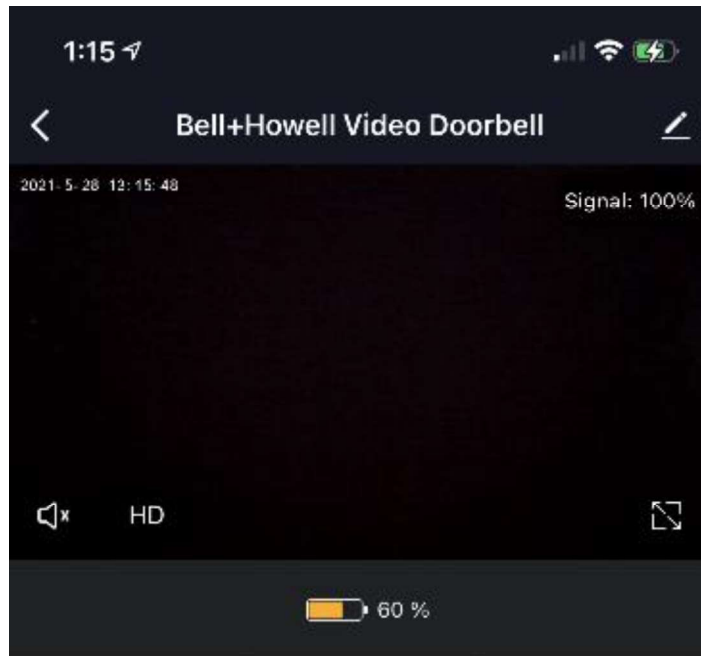

Screenshot



Speak



Record



Playback



Photo album

- 10. From here, you can take screenshots of a live image, speak through the doorbell, record the live view, playback previously recorded events and view previously captured screenshots.
- 11. You can also change the device settings by selecting the pencil icon at the top right corner of the live view screen. From there you can change the name and the settings for the doorbell.

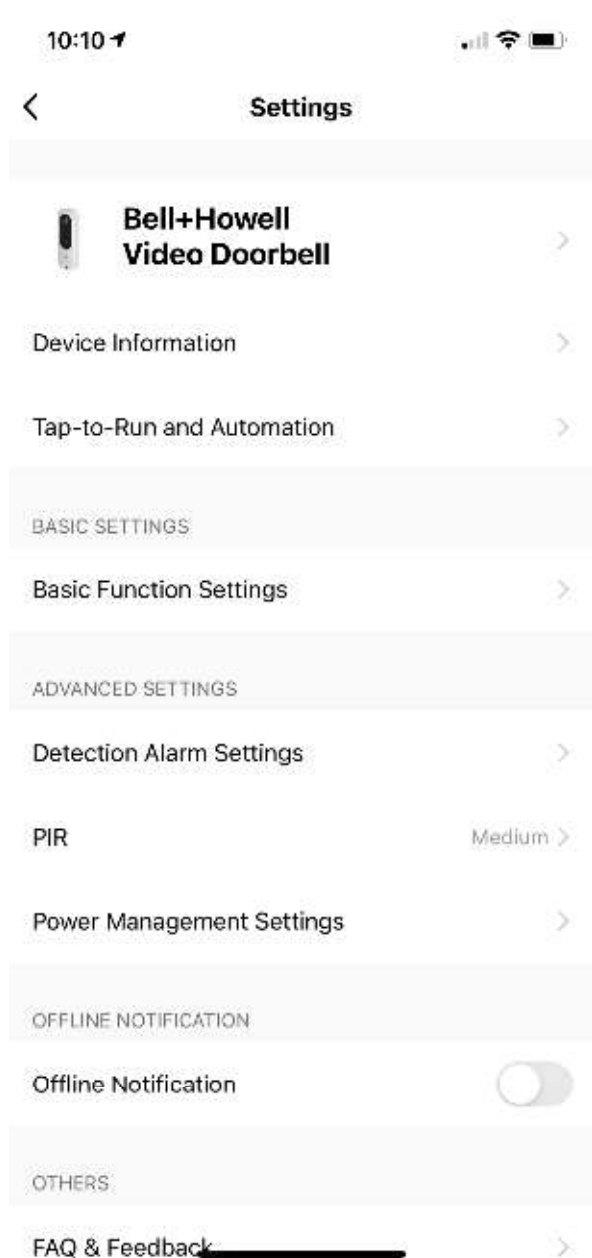
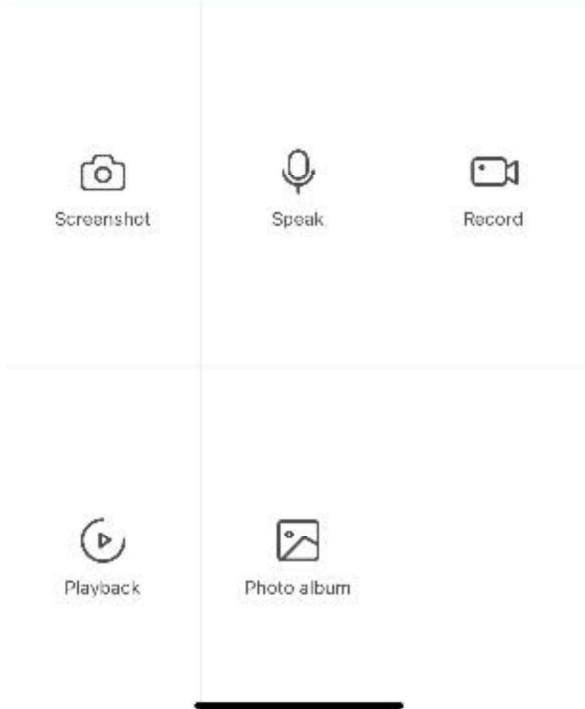
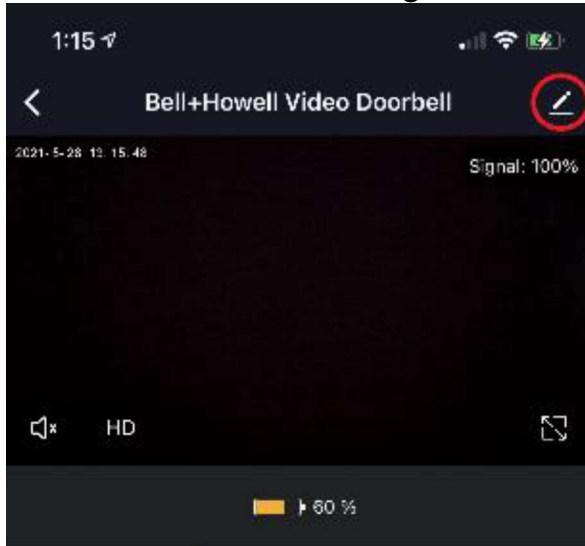

3.2 Connecting the Chime to the Doorbell

You can hear doorbell ring alerts from anywhere in your home through the chime accessory without the need for a smart device. Follow the steps below to connect the chime to your doorbell:

1. Remove the rear cover of the chime and open the battery door. Install the included batteries, make sure that they are installed in the correct orientation, then replace the battery door.
2. Press and hold the volume button until the LED indicator on the front of the chime turns on.
3. Press the button on the doorbell to complete the connection to the chime.
4. Once connected, the chime will sound whenever the doorbell button is pressed.
5. To change the volume level on the chime, press the volume button to cycle through the volume levels.
6. To change the ring tone, press the up or down buttons on the side of the chime to select your desired ring tone.
7. The chime can now be placed in a location of your choosing in your home. It is for indoor use only and should not be placed outdoors.
8. To connect multiple chime units to the same doorbell, perform the steps above for each individual chime.

Note: Multiple chimes can be connected to the same doorbell. A chime can only be connected to one doorbell at a time. The chime must be unpaired from the doorbell before pairing to a new doorbell.

To unpair the chime from the doorbell, press and hold the volume button for 10 seconds. This will disconnect the chime from the doorbell. To reconnect the chime to the doorbell, follow the steps above.

3.3 Mounting the Doorbell

Your doorbell can be mounted securely to the outside of your home, follow the steps below to mount your doorbell.

1. Using the mounting bracket as a template, mark the three holes where the screws will go. The recommended installation height is 4 feet above the ground. You can also check the live view from the app to pick your desired doorbell height.
2. If you're installing your doorbell on stucco, brick or concrete, use a 1/4" masonry drill bit to drill holes in your wall at the marked locations. Insert the included anchors into the hole. If you're installing the doorbell on wood, skip this step.
3. Place the mounting bracket on the wall and align it with the anchors or the marked locations. Using a Philips head screwdriver, drive the screws into your wall (or into the anchors, if installed) until they are flush with the mounting bracket.
4. As alternative, you can mount your doorbell using the included double sided tape. Simply peel off one side of the tape and press it firmly to the back of the mounting bracket, then peel off the second side of the tape and press the mounting bracket firmly to the desired location.

Note: Only use the double sided tape if you are mounting the doorbell to a completely flat surface, any surface bumps or irregularities might cause the tape to fail. Before mounting, clean the desired mounting area very well and make sure the surface is dry before mounting.

5. Next, slide the top of the doorbell into the top of the mounting bracket, then slide in the bottom. Then install the security screw into the bottom of the bracket. This will secure your doorbell to the bracket. The security screw must be removed to be able to remove the doorbell from the mounting bracket.

Note: DO NOT USE any screw other than the included short security screw when securing your doorbell to the bracket.

3.4 Mounting the Chime

Your chime can be placed on a surface or mounted on an indoor wall or surface, follow the steps below to mount your chime.

1. Slide the mounting bracket off of the back of the chime. Using the bracket as a template, mark the two holes where the screws will go.
2. Follow the correct installation instructions based on the anchors you plan to use. Use a drill bit size that is recommended for the anchors you are using. Insert anchors (not included) into the hole. If you're installing the doorbell on wood, skip this step.

3. Place the mounting bracket on the wall and align it with the anchors or the marked locations. Using a Philips head screwdriver, drive the screws (not included) into your wall (or into the anchors, if installed) until they are flush with the mounting bracket. As alternative, you can mount your chime using the included double sided tape. Simply peel off one side of the tape and press it firmly to the back of the mounting bracket, then peel off the second side of the tape and press the mounting bracket firmly to the desired location.

Note: Only use the double sided tape if you are mounting the chime to a completely flat surface, any surface bumps or irregularities might cause the tape to fail. Before mounting, clean the desired mounting area very well and make sure the surface is dry before mounting.

4. Next, reattach the chime to the mounting bracket.

4.1 Technical Specifications

Model Number	Video Doorbell: Bell+Howell BHDC1A Chime Accessory: Bell+Howell BHCH1A
Lens	Fixed Focus • 110° Field of View
Shutter	Electronic
Pixels (video)	H.264: 1080p Full HD 30fps
Connectivity	WiFi 2.4GHz (802.11 b/g/n)
Motion Detection	High Sensitivity PIR Sensor
Detection Range	5 Feet
Weather Resistance	Water and Dust Resistance (IP54, when installed in mounting bracket)
Night Vision	Infrared LEDs (Auto Switching)
App	Tuya Smart (iOS & Android)
Chime Ring Tones	35 Ring Tone Options
Chime Volume	4 Volume Levels
Recording Media	MicroSD • MicroSDXC with Compatible High Quality Brands; Maximum: 64GB
I/O Ports	Micro USB, USB 2.0 (high speed) • Speaker
Power	18650 x 2; 3.7v, 2 x 2,600mAh (5,200mAh Total)
Dimensions	5.5 x 1.8 x 1.2 in. • 6.6 oz.

BELL+HOWELL

*Distributed under license of BHH LLC in the United States by:
Elite Brands Inc.*

*40 Wall Street, 61st Floor,
New York, NY 10005 USA*

Tel: 800-441-1100

www.elitebrands.com

Copyright © 2021 Elite Brands Inc.

***If you're having difficulties with your camera, or would like further assistance,
please call our toll-free technical support hotline at 800-441-1100. Please be
sure to have your camera handy when calling.***



